



## Kumulani at the Uplands Check-In Directions

**\*\*\*\*\*Please call 808-885-4944 before leaving the Kona Int'l Airport\*\*\*\*\***

**Mauna Lani Terrace  
68-1399 Mauna Lani Dr.  
Mauna Lani Resort  
Kamuela, HI 96743**

**Check-in Office (Open daily): 9 a.m. - 5 p.m.  
Phone: 808-885-4944 / Fax: 808-885-4022  
Check-in time: After 3:00 p.m.  
Check-out time: 11:00 a.m.  
After Hours & Property-Related Emergencies: 808-885-4944**

**\*\*Attention: South Kohala Management manages many resort properties on the Kohala Coast. All guests of a Mauna Lani or Mauna Kea Resort property will check-in at our Mauna Lani Terrace check-in office. Please read the check-in directions provided below carefully and call us if you need any assistance.**

### **Directions from Kona International Airport, Big Island of Hawaii:**

Upon arrival to the Kona International Airport, please call 885-4944 to let the staff know of your arrival. Exit the airport and turn left (north) onto Queen Kaahumanu Highway (Highway 19). Drive for approximately 19.5 miles and turn left into the Mauna Lani Resort. At the traffic round a bout, take the second exit towards the Mauna Lani Bay Hotel and Bungalows. The entrance to the Mauna Lani Terrace will be your second left. Our check-in office is located to the left of the entrance gate (gate entry NOT required) and you can park in any of the three stalls.

### **Check-in time is 3:00 pm:**

If you are checking in between 3:00 - 5:00 p.m. a front office staff member will be available to personally check you in. Early check-in and late check-out can be requested within 24 hours prior to arrival or departure and may be granted for a fee. Please call the Mauna Lani Terrace office at 808-885-4944 the day before you arrive if you would like to request an early check-in and the day before departure if you would like to request a late check-out.

### **After hours check in instructions:**

Please follow the same check-in procedures as you would during normal business hours and proceed to the Mauna Lani Terrace office. An "After Hours Check-In" box is located to the right of the entrance door of our check-in office. Please call 885-4944 from the house phone located in the box and give the answering service your name and that you are calling to check-in. They will give you the combination to open the lock box (right below the phone). A packet with your name on it will be in the lock box and it will contain all the information you will need to access your property. Please be aware that there are not street lights in all areas of the resort and some properties are not easily visible at night. Make sure that you read everything in your packet carefully as we have provided detailed instructions to help you locate your property with ease. **If you are unsure of the check-in procedures, please call (808) 885-4944; a staff member is available 24 hours to assist you.**

Please come to the Mauna Lani Terrace office the following morning to complete your registration process with South Kohala Management.

### **Directions from the Mauna Lani Terrace to Kumulani at Mauna Kea:**

As you exit the Mauna Lani Terrace, turn right onto Mauna Lani Drive. Proceed to the round a bout and take the second exit on your right (heading back toward Queen Kaahumanu Highway). Once you've reached the highway, turn left and continue for approximately 8 miles. Turn right at the Hapuna Beach Prince Hotel entrance and proceed to the security gate and give them your name. After the security gate, take the second left on to Amaui Drive. The entry gate for Kumulani will be your second left at Lolii Way. Once you have accessed the gate, please refer to your Kumulani map for your exact unit location.

**(A map of the check-in office & your property is located on the back of this page)**

# Mauna Lani Resort

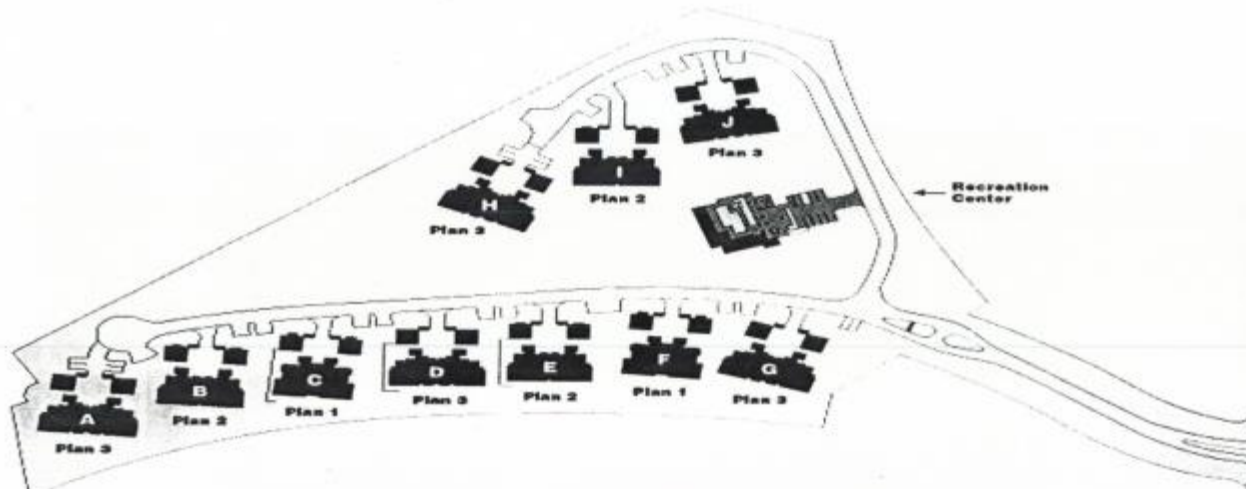
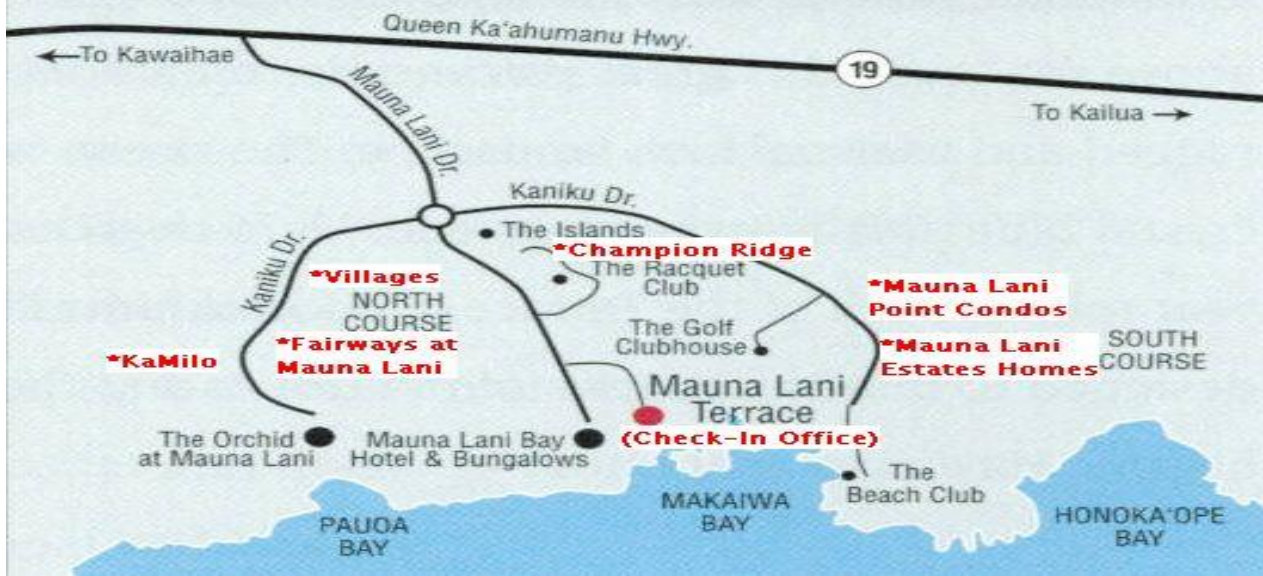

*The Kumulani at The Uplands  
at Mauna Kea*  
The Island of Hawaii